



Bond Proposal Projects

Boyne City High School

How would bond projects enhance the learning environment at the high school?

Interior/Exterior Site Improvements

New LED lighting would be installed in the gym, cafeteria, and main hallways to enhance energy efficiency and improve visibility. Separately, the furniture, which has been in use since the high school opened 24 years ago, would be replaced to update and modernize these spaces.

Vocational/CTE Enhancements at Boyne City High School

Vocational education is essential for all BCPS students, and over 141 BCPS students are enrolled in vocational programming. Many vocational programs are called Career and Technical Education (CTE) programs and receive some funding for staff and equipment to run the programs for high school students. Unfortunately, our Char-Em ISD millage that supports CTE programs does not allow “brick and mortar” improvements to be funded with CTE funds. Local school district tax-payers must pay for building additions like the ones proposed in the May 2025 bond.

The bond proposal would allow BCPS to construct program spaces for enhanced CTE programming. The first space is a 5,000 sq/ft lab space and classroom for the Building Trades & Electrical Lineman program. This would allow for more efficient teaching and learning. Construction simulations would allow Building Trades students to practice in the lab before working on the house in our community that the school district constructs each year. Similarly, the Lineman program would be able to climb utility poles and simulate work conditions inside before heading to the outdoor lab at Great Lakes Energy, where they climb full-size poles and incorporate trucks and other equipment with the natural elements.

The second space would support the Hospitality program, which teaches high school students the culinary skills needed to work in our region’s robust restaurant industry. Currently, the classroom and kitchen are not located on campus, limiting the time for instruction and separating the program from the rest of the high school culture. The addition would create a mini-restaurant for students to host and cook for community groups, parents, and fellow students, and a current classroom would be remodeled to serve as the teaching kitchen for our instructor and students.

A conceptual floor plan of the new spaces at the high school is on the next page.

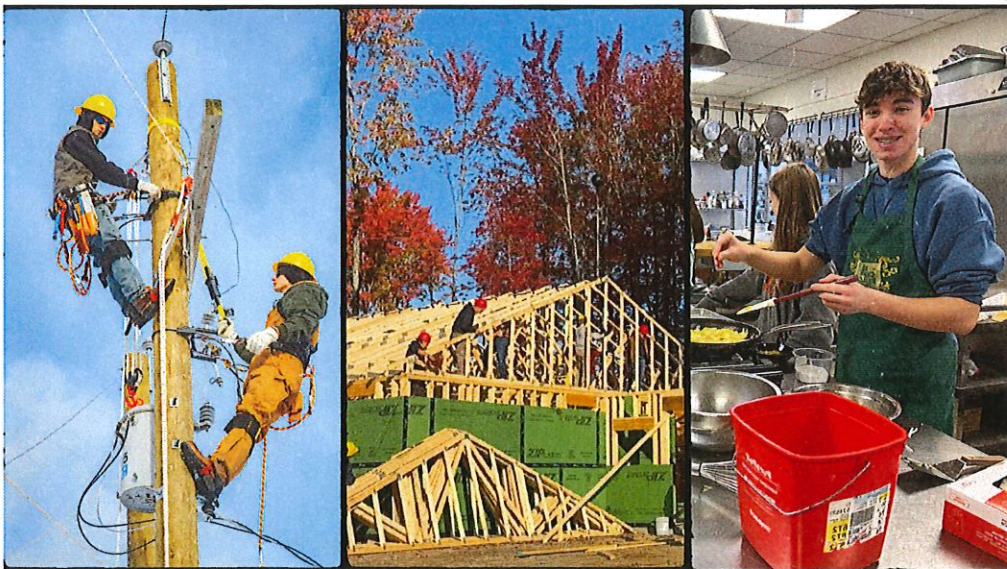



Bond Proposal Projects

Boyne City High School - Concept Floor Plan

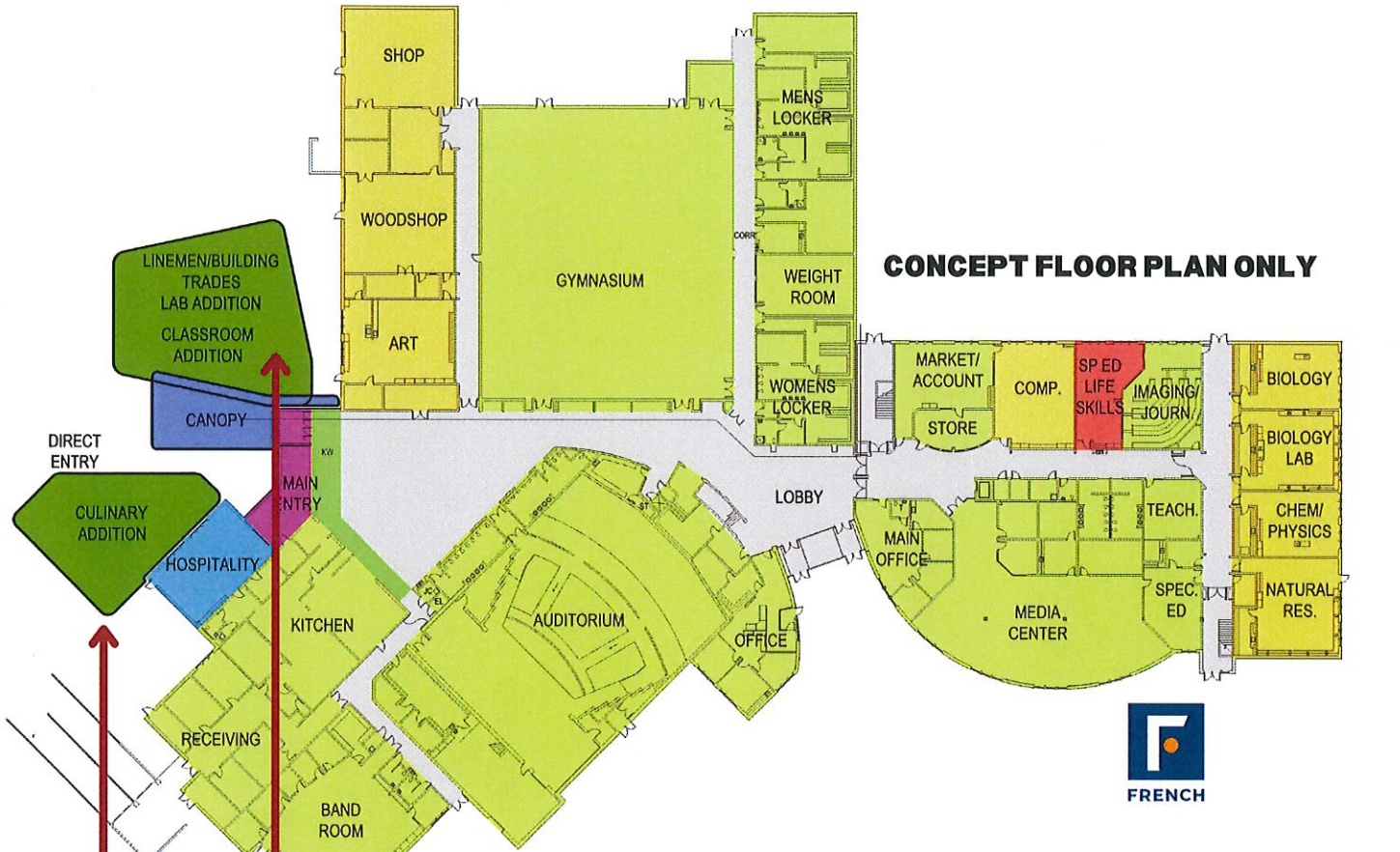

CTE/Vocational program additions

Legend:

- addition - linemen/building trades/ lab/classroom**
CTE space, classroom, lab space, mezzanine, floor sleeves, glass wall for visibility, oh doors.
- addition - culinary**
main entry, fse.
- heavy remodel - hospitality**
range hoods.
- heavy remodel / addition - corridor**
- existing corridors**
cabinet unit heaters (ignyte to provide options), lighting
- moderate remodel - kalwall**
repair kalwall above.
- existing classrooms**
lighting.
- existing accessory spaces**
increase hvac in support auditorium spaces.
- heavy remodel - special ed life skills**
w/d, sink, range, appliances, countertops.
- addition - canopy**
- moderate remodel - main entry**