

» MARCH 2026 REFERENDUM PUBLIC PRESENTATION

Strong School, Strong Community!

 **SOLUTIONS**
ARCHITECTURE
FRANK A. MESSINEO • AIA



PROJECT SCOPE

» PROJECT CATEGORIES



Learning

ENHANCED LEARNING
ENVIRONMENTS



Safety

STUDENT & STAFF
SAFETY



Operations

KEEP UP-TO-DATE
WITH OPERATIONS



FACILITIES ENHANCE LEARNING

» SCHOOL CAPITAL PROJECTS



THE SCHOOL WILL RECEIVE . . .



- Sitework - Creation of a secondary short-term drop off / pick up or lane on Tappan Road which will provide a longer queue or parking for cars and lessen the burden on the front drop off area.
- Multipurpose Room, Cafeteria and Toilet Room Access Controls for lock-down scenarios and safety protocols.
- Pre-K Toilet Room Upgrades
- ADA General Toilet Room Upgrades
- Roofing Section Replacements

PROJECT SCOPE - CAPITAL PROJECTS

» ROOFING SYSTEM REPLACEMENTS

SCHOOL
REIMAGINED



■ WHY ROOFING SECTION REPLACEMENT?

- The District is proposing to replace the aging 23,100 square foot roofing system over the 1967 section of the building, which is currently out of warranty and beyond its useful life. This roof replacement will head off failures that could result in leaks that disrupt the building's functionality and require costly ongoing maintenance.
- By upgrading these roof sections, the District will address water infiltration issues, improve energy efficiency, and upgrade the roof drainage system, ensuring long-term protection of the facility and more comfortable environment for students and staff.

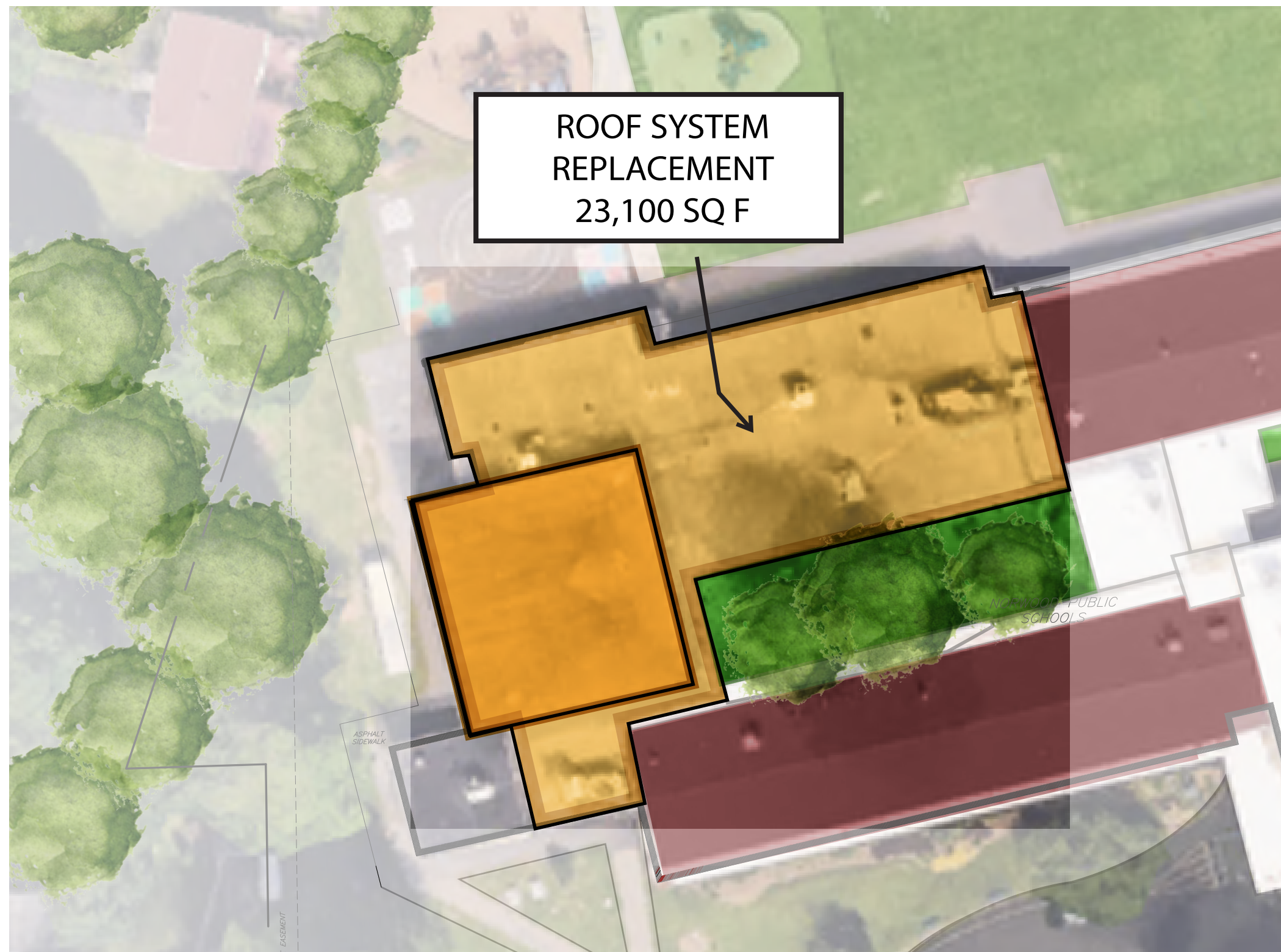

» UPGRADE EXISTING TOILETS

SCHOOL
REIMAGINED

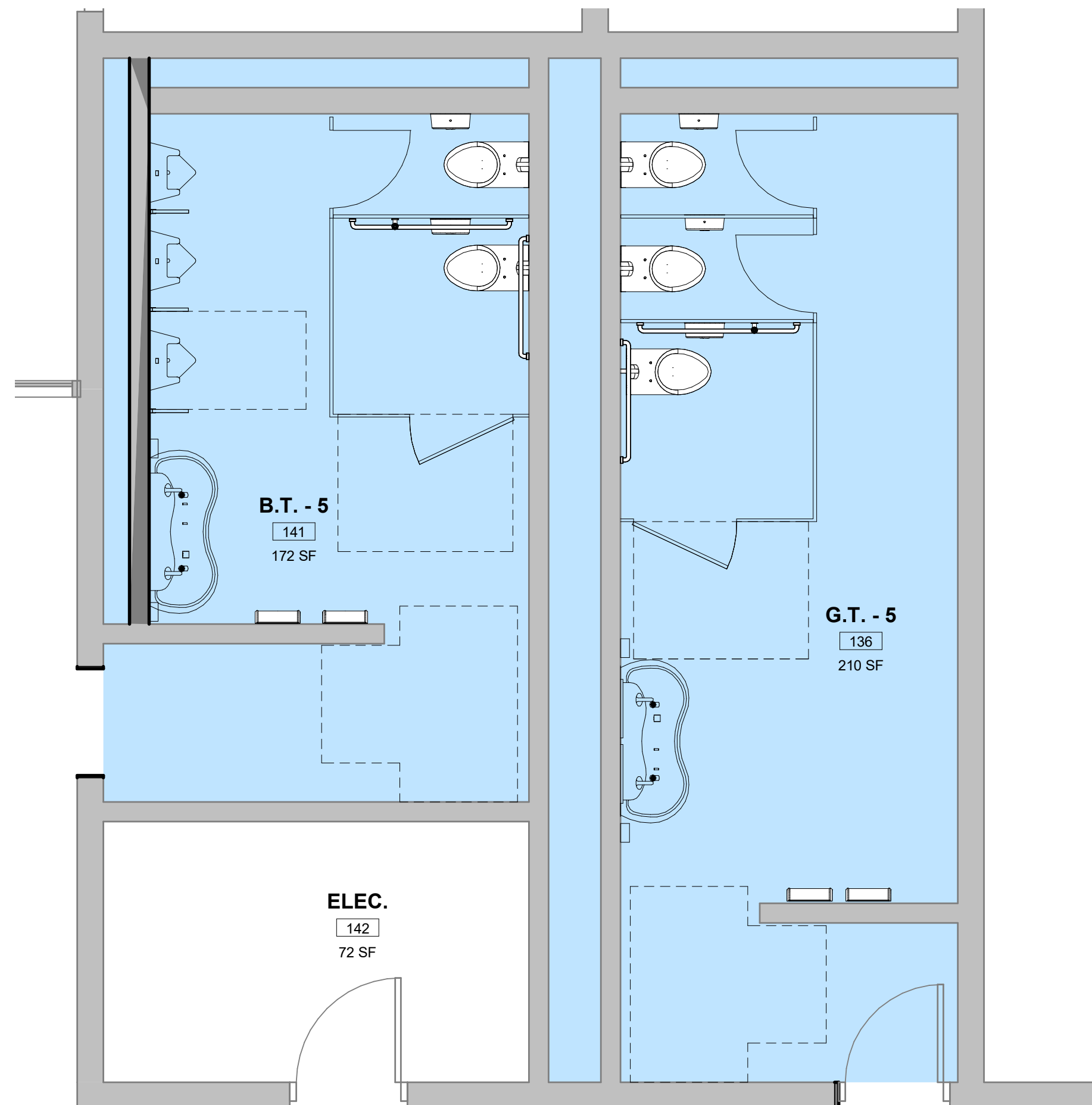

- WHY RENOVATE (2) EXISTING TOILET ROOMS NEAR GYM FOR PUBLIC USE?
- To expand equal access for all individuals, the District is proposing to renovate two existing general Toilet Rooms near the Gymnasium to meet current ADA accessibility standards.
- These upgrades will expand accessible facilities for students, staff, and community members with disabilities, further supporting inclusivity and reinforcing the District's commitment to upholding the standards of the Americans with Disabilities Act.

» ADD CLASSROOM TOILETS

SCHOOL
REIMAGINED



■ WHY CONSTRUCT (2) NEW CLASSROOM TOILETS FOR REASSIGNED PRE-K CLASSROOMS

- To meet state requirements for licensed Kindergarten and Pre-K classrooms, the District must reassign classrooms and construct individual toilet rooms within two rooms
- This essential upgrade enables the creation of two fully compliant Pre-K classrooms, expanding early childhood education opportunities within the District. By providing age-appropriate facilities, the project ensures a safe, accessible, and developmentally suitable environment for our youngest learners.

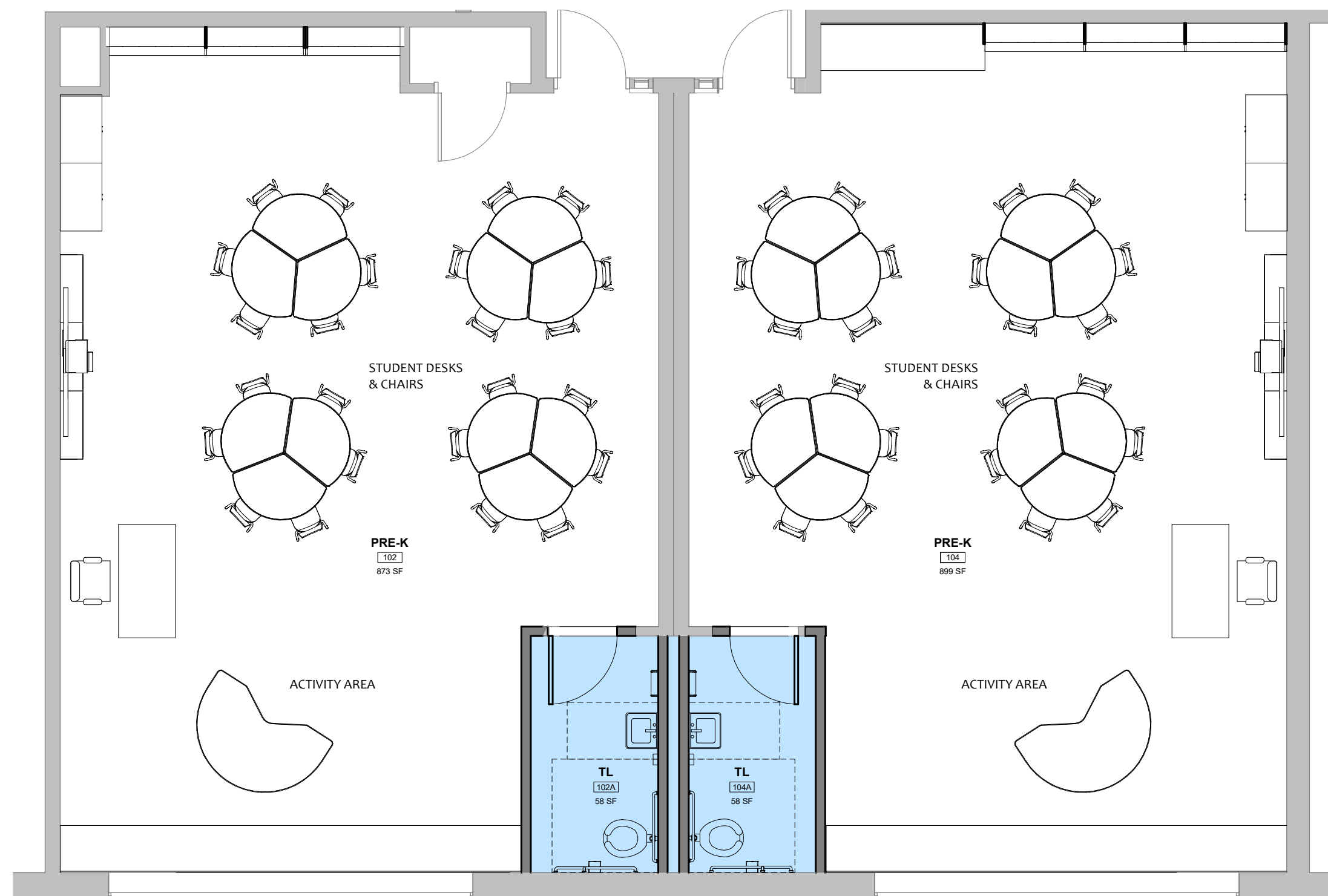

» LOCKDOWN/ACCESS CONTROLS

SCHOOL
REIMAGINED



■ WHY PROVIDE LOCKDOWN/ACCESS CONTROLS FOR KEY SPACES IN THE BUILDING?

- To enhance the overall safety and emergency preparedness of the school facility, the District is proposing to install lockdown and access control systems for key areas of the building, including toilet rooms, the Multipurpose Room, and the Cafeteria.
- These systems will allow staff to secure and restrict access to these spaces during a critical incident, such as an active shooter event, thereby improving the District's ability to protect students, staff, and community members during emergencies.

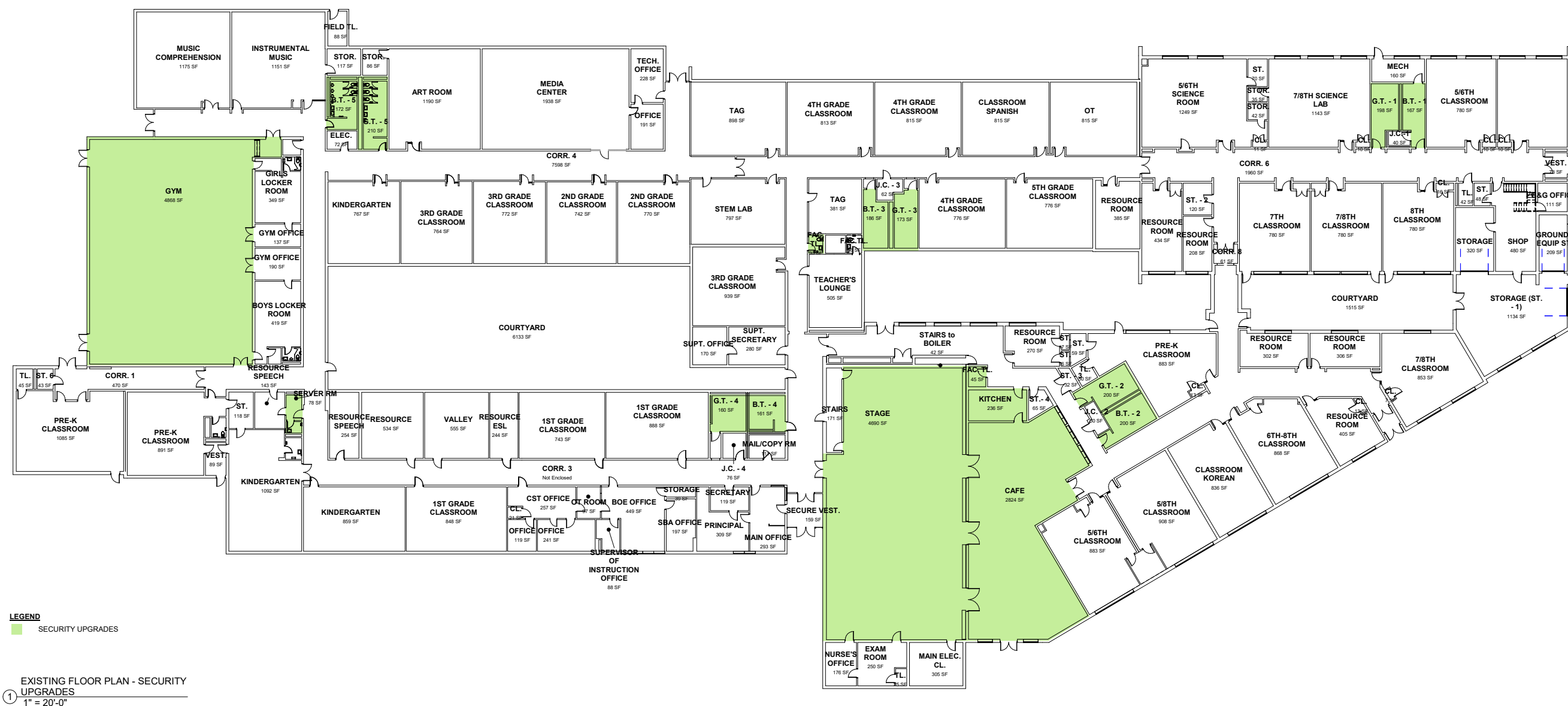

» ADD A FORMAL DROP OFF / PICK UP LANE ON TAPPAN ROAD

SCHOOL
REIMAGINED



- **ADDING A SHORT-TERM DROP OFF LANE FOR PARENT DROP OFFS ON TAPPAN ROAD**
 - To improve safety, traffic flow, and delays with arrival and dismissal procedures, the District is proposing to construct a curb cut with parallel drop off spaces for parent drop off / pick up.
 - This new drop off lane will allow parents to do what they are currently doing, however in a safer manner than what is currently occurring - parking on the lawn area and walking students in. This enhances safety for students, staff, and the general public. Students will be required to walk around to the front of the building for entry.

PROJECT SCOPE -

EDUCATIONAL PROJECTS

(2) CLASSROOM ADDITION

» WHY CONSTRUCT A MODULAR ADDITION?

SCHOOL
REIMAGINED

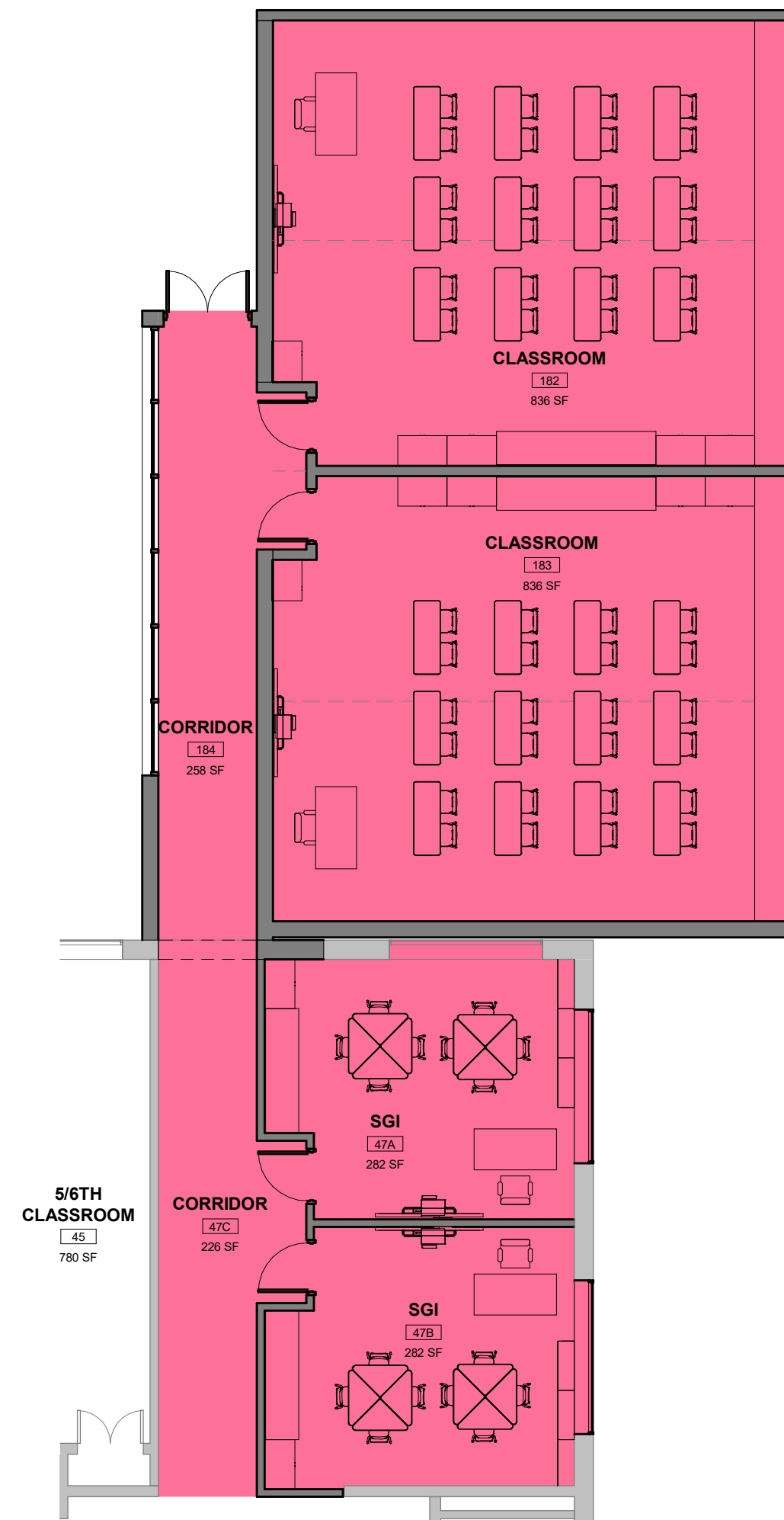
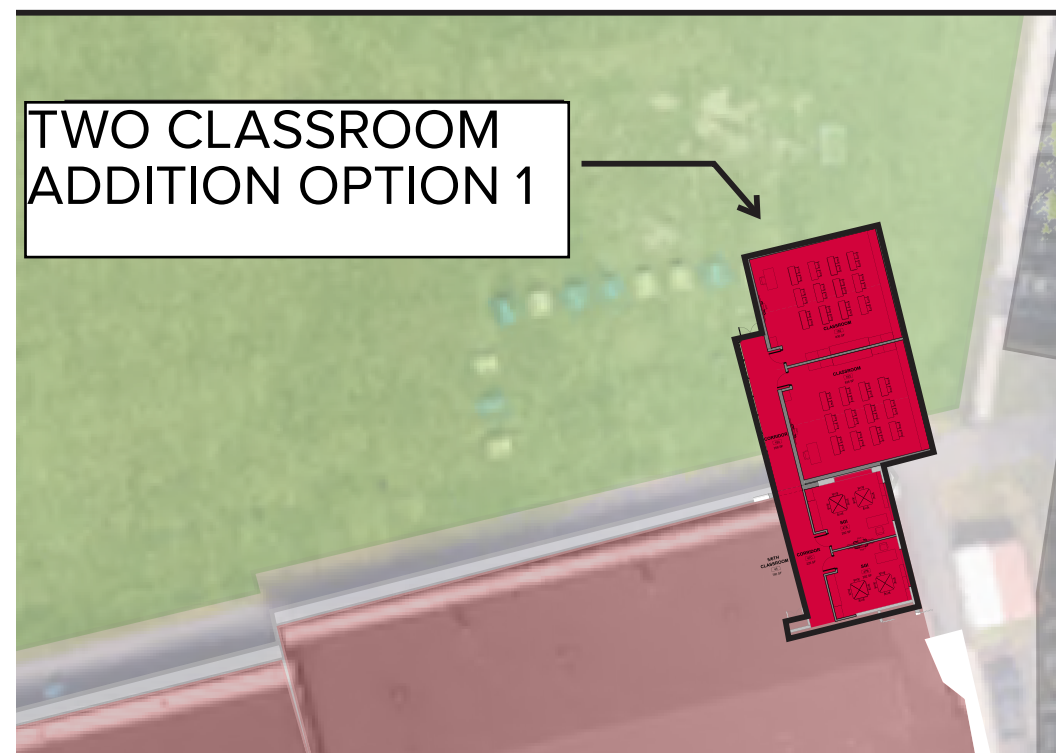

- **CONSTRUCTING A NEW (2) CLASSROOM ADDITION- INTERIOR CORRIDOR THRU EXISTING CLASSROOM BUT ADDING TWO SGI CLASSROOMS**
- This two-classroom addition will allow the District to bring back out-of-district placements for Special Education, Least Restrictive Environment, creating a more inclusive learning environment while significantly reducing costly tuition payments to other districts.
- By investing in this expansion, the District not only strengthens its educational offerings and keeps students closer to home, but also generates long-term savings by avoiding recurring out-of-district placement costs, making this a fiscally responsible and student-centered solution.

» INTERIOR CLASSROOM RENOVATIONS

SCHOOL
REIMAGINED



■ CONSTRUCTING THE (2) CLASSROOM ADDITION - WILL SACRIFICE A FULL SIZE CLASSROOM

- The existing full sized classroom will become a corridor and (2) SGI Classrooms. We will reclaim that full sized classrooms by combining (2) existing SGI Classrooms 10 & 12 into a larger room.
- The resulting room will be used for MD (Multiply Disabled) student instruction.

ENLARGED FLOOR PLAN- CLASSROOM

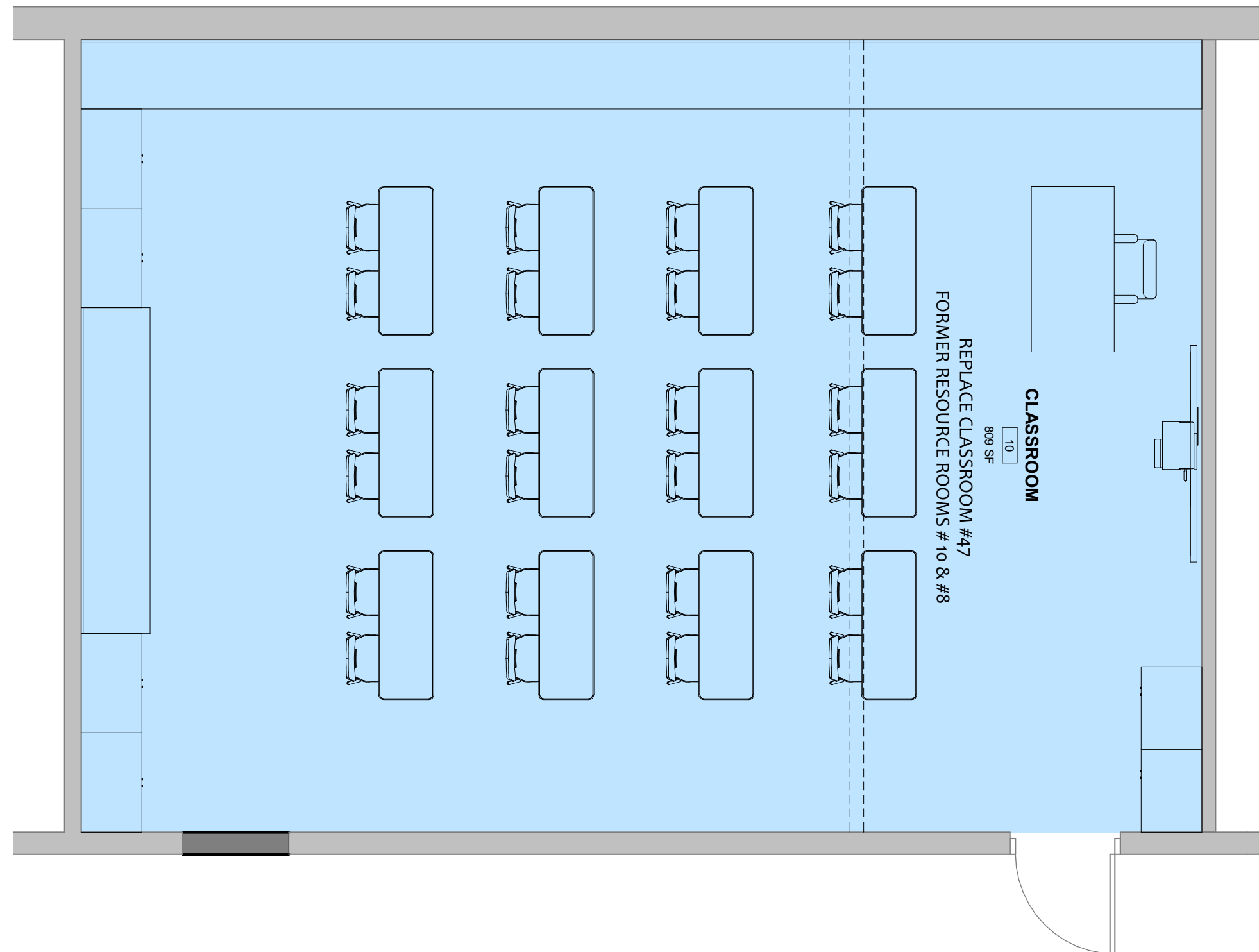

» MODULAR APPEARANCES ...

SCHOOL
REIMAGINED





For further information and to keep updated on the District-wide Facilities Renovation Program Referendum, please scan the QR Code to the left or visit the district website:

www.wearenorwood.org/page/referendum

SOLUTIONS ARCHITECTURE | FRANK MESSINEO, AIA

fm@solutions-arch.com | www.solutions-arch.com

973-484-4800 (OFFICE) | 201-618-0606 (CELL)