

Google Chrome - Can't use this profile error

To remove the original google chrome profile:

- Click the 3 little dots on the top right of your name (person 1,2,3,4,etc)
- Click Delete
- Confirm Delete (red button)

Click the add button and sign back in

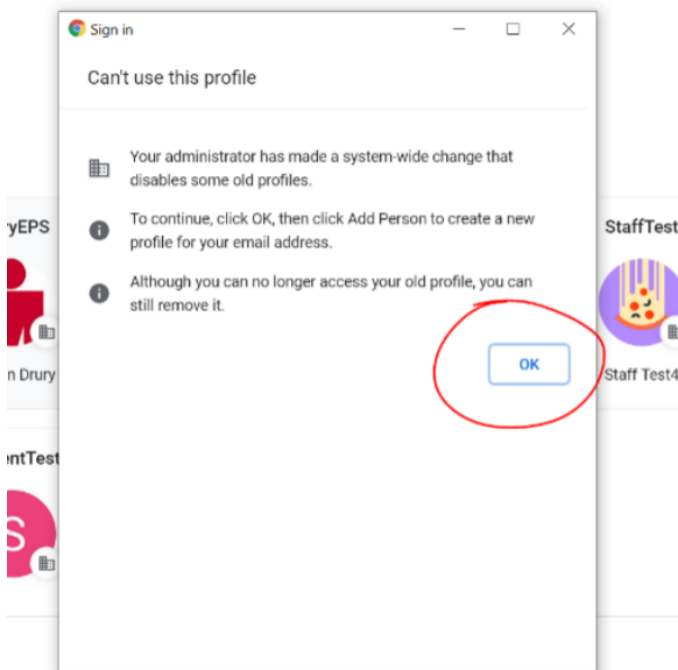

Click the 3 little dots in the corner

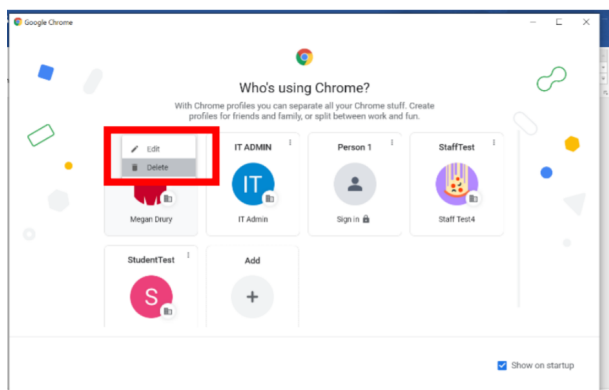

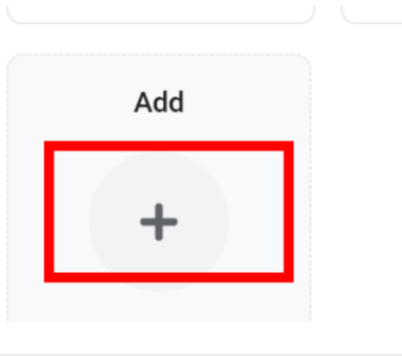
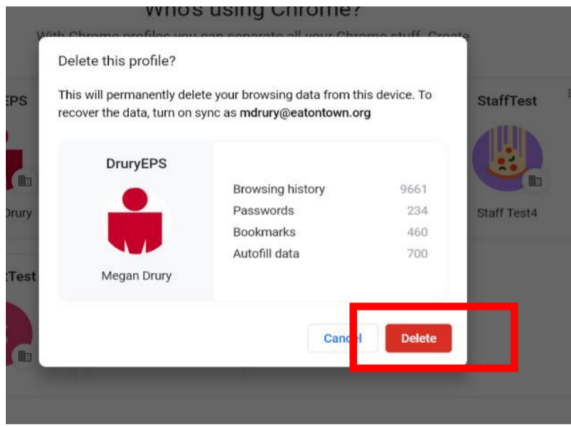

Do NOT put mdrury
but put your username
and make sure you put
@eatontown.org

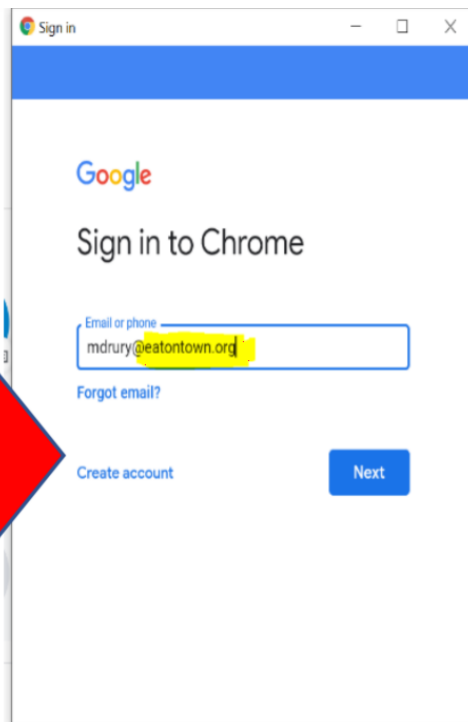



Turn on sync?

Sync your bookmarks, passwords, history, and more on all your devices
Google may use your history to personalize Search, ads, and other Google services

You can always choose what to sync in settings.

[Settings](#)

[Yes, I'm in](#)

[Cancel](#)

Revision #4

Created Tue, Aug 24, 2021 10:49 AM by [Megan Drury](#)

Updated Wed, Jan 11, 2023 5:40 PM by [Megan Drury](#)